

STANDARD LATCH CONTRA CONTINENTAL

20,000 R.P.M. AUTOCLAVABLE



STANDARD LATCH CONTRA CONTINENTAL is highly engineered to assure precise operation and long life with correct operation and proper care.

COMPONENT PARTS:

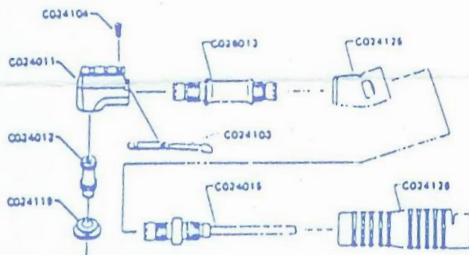

MAINTENANCE:

To keep the best operating condition, regular cleaning and constant lubrication is essential.

Cleaning:

Connecting Contra Angle to handpiece, turn it in slow speed immersing in the cleaning oil bath for two minutes. All foreign particles are removed.

After foreign particles are removed, wiped the cleaning oil off completely.



Lubrication:

After the cleaning, lubricate to all gear, shaft, cap and head cavities through oil holes located at rear head and sheath.

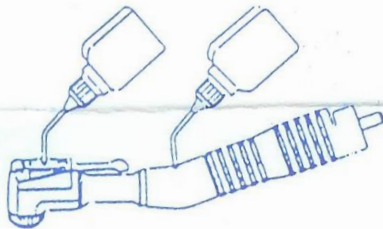

STANDARD LATCH CONTRA CONTINENTAL

20,000 R.P.M. AUTOCLAVABLE



STANDARD LATCH CONTRA CONTINENTAL is highly engineered to assure precise operation and long life with correct operation and proper care.

COMPONENT PARTS:

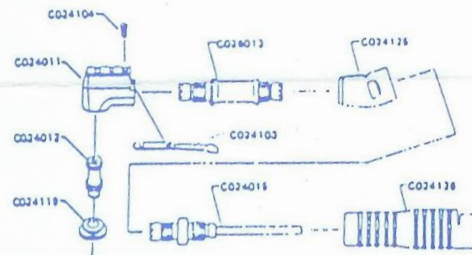

MAINTENANCE:

To keep the best operating condition, regular cleaning and constant lubrication is essential.

Cleaning:

Connecting Contra Angle to handpiece, turn it in slow speed immersing in the cleaning oil bath for two minutes. All foreign particles are removed.

After foreign particles are removed, wiped the cleaning oil off completely.

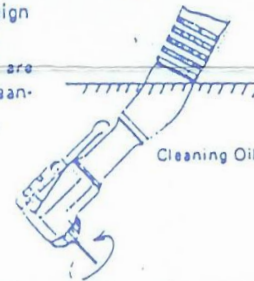

Lubrication:

After the cleaning, lubricate to all gear, shaft, cap and head cavities through oil holes located at rear head and sheath.

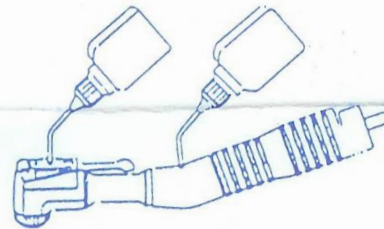

Johnson-Promident
618 Corporate Way Unit 1 Valley Cottage, NY 10989
Phone 845-589-0210 Fax 845-589-0211